

GENERAL

- ① NOT USED
- ② NOT USED

PINK

- ~~21) PINK ARMOIRE FIXTURE. REFER TO DETAIL L/ARMOIR FOR ATTACHMENT AND LADDER RAIL DETAILS.~~
- ~~22) BRASS HOOKS, MOUNTED VERTICALLY. REFER TO DETAIL L/ARMOIR.~~
- ~~23) NOT USED~~
- ~~24) NOT USED~~
- ~~25) BRASS HOOK. ATTACH WITH VENDOR SUPPLIED SCREWS. IF BLOCKING AND/OR WOOD TRIM IS NOT PRESENT USE HILTI HPF GYP. BD. ANCHORS. REFER TO DIFFERENT ELEVATIONS FOR HEIGHT.~~

VSS

- 141) BRA WARDROBE FIXTURE. REFER TO DRAWING 1/A11.08 FOR ATTACHMENT.
- 142) LIGHTBOX TOWER FIXTURE. REFER TO STOREFRONT ELEVATION FOR GRAPHIC TAG CALLOUT.
- 143) NOT USED
- 144) VSL ACCESSIBLE FITTING ROOM BENCH - REFER TO 1/A11.08
- 145) CRYSTAL GLOBE INSTALL ON COLUMN FACE @5'-3" A.F.F. G.C. TO INSTALL W/ VENDOR PROVIDED TOGGLE BOLTS.
- 146) ILLUMINATED PORTAL SIGNBOX. REFER TO STOREFRONT SECTIONS FOR MOUNTING. REFER TO ELEC. DWGS. FOR POWER REQUIREMENTS.
- 147) ROD-SUPPORTED-DRAWERY-MOUNTED-TO-TRANSITION-ABOVE-TRANSITION. REFER TO DETAIL 1/A11.08

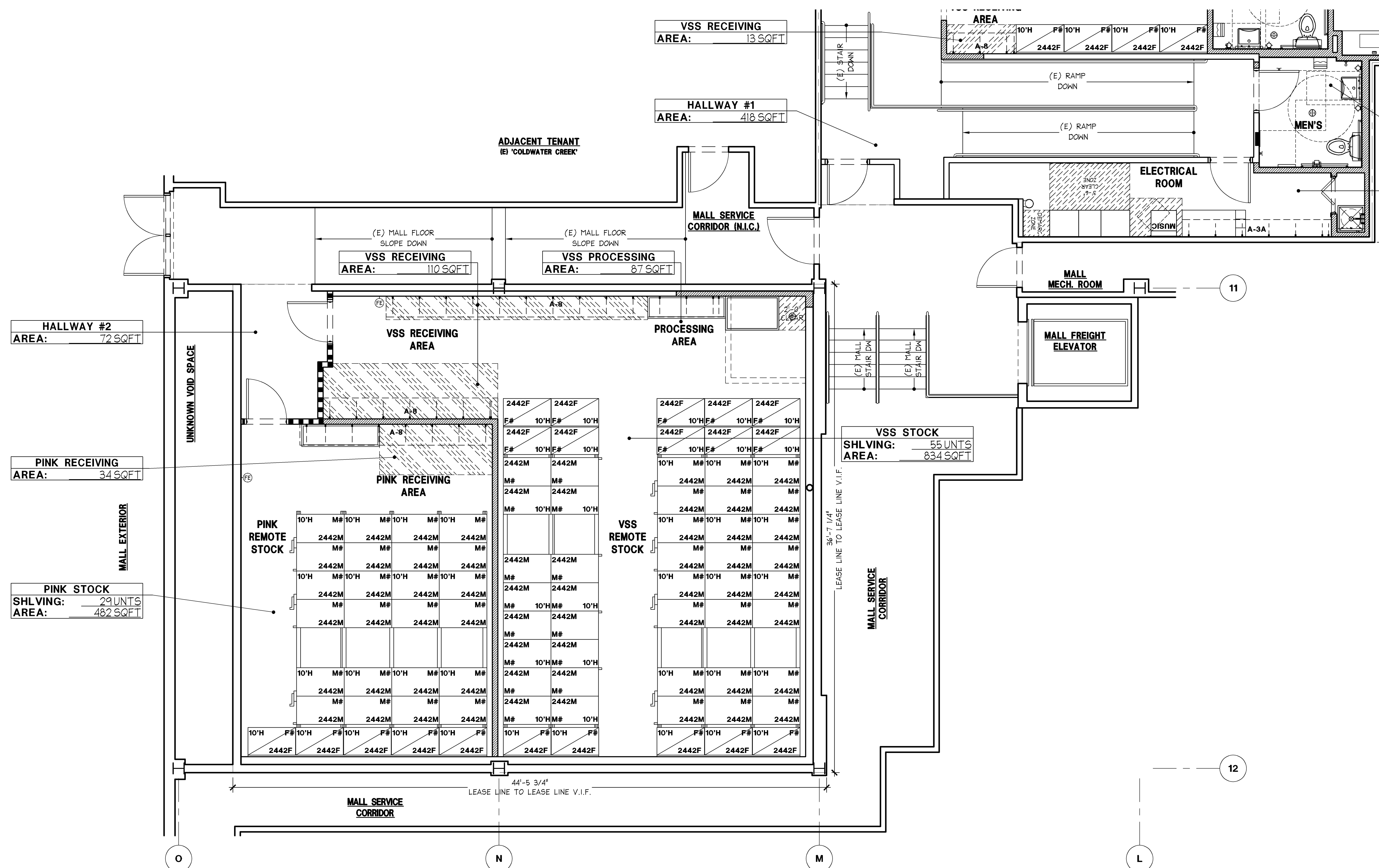

NON-SALES / ASSOCIATE AMENITY AREA BREAKDOWN

1 PERSON MANAGER OFFICE	
2 PERSON MANAGER OFFICE	
3 PERSON MANAGER OFFICE	X
BREAK AREA	
BREAK ROOM	X
MULTIUSE ROOM	
OPS OFFICE	
OPS/CASH OFFICE	
TRAINING ROOM	
DSM OFFICE	
RSM OFFICE	

REFER TO SHEET A00.03
FOR FIXTURE SCHEDULE

REFER TO INTERIOR
ELEVATIONS AND SHEET
A00.04 FOR PINK GRAPHIC
PLACEMENT AND SCHEDULE

PRESENTATION AND FIXTURE PLAN

1/4" = 1'-0"

A

DRAWING NUMBER: